

TA907

Mounting Dimension

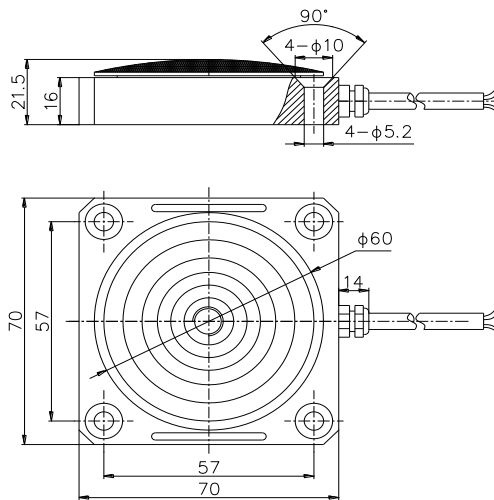

Features & Applications

- Compact structure, easy to install
- IP65 protection
- Used to measure the brake pedal force in the car development industry

Specifications	Technique
Capacity	500,1000, 1500, 2500, 5000N
Rated output	1.5 ± 10% mV/V
Zero balance	±2% F.S.
Non-linearity	0.2%F.S.
Hysteresis	0.1%F.S.
Repeatability	0.1%F.S.
Creep(30min)	0.05%F.S.
Temp.effect on output	0.05%F.S./10°C
Temp.effect on zero	0.03%F.S./10°C
Input impedance	780 ± 30Ω
Output impedance	700 ± 10Ω
Insulation	≥5000MΩ/100VDC
Recommended excitation	5~15V
Maximum excitation	20V
Compensated temp range	-10~60°C
Operation temp range	-20~80°C
Safe overload	120%F.S.
Ultimate overload	200%F.S.
Cable size	Φ4×2000mm
Material	aluminum alloy
Weight approx.	0.4kg
IP Class	IP67

Load Direction

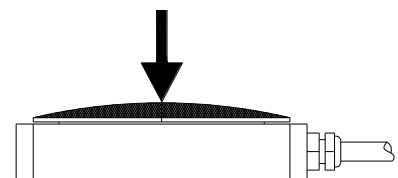

Wiring Code

